





7 Lutea Place Forster NSW

4  2  4 

- ** Spacious four bedroom, two bathroom single level family home in the prized Palms Estate
- ** Light-filled lounge & dining areas; large open plan living with air-conditioning
- ** Expansive timber kitchen with breakfast bar; dishwasher, electric cooktop & abundant storage
- ** Master with WIR & ensuite; additional bedrooms with built-ins
- ** Family bathroom with a large corner bath and convenient separate toilet
- ** Generous alfresco area overlooking lush yard; internal laundry with external access
- ** Oversized triple garage with drive-through to carport or extra outdoor living space
- ** Public transport is nearby, and Stockland Forster

Type : House
Land Size : 648.8 sqm
View : <https://www.tuncurryfn.com.au/lease/nsw/mid-north-coast/forster/residential/house/8459930>



Melissa Hillsley
02 6554 5011

[For full version visit the website](https://www.tuncurryfn.com.au)

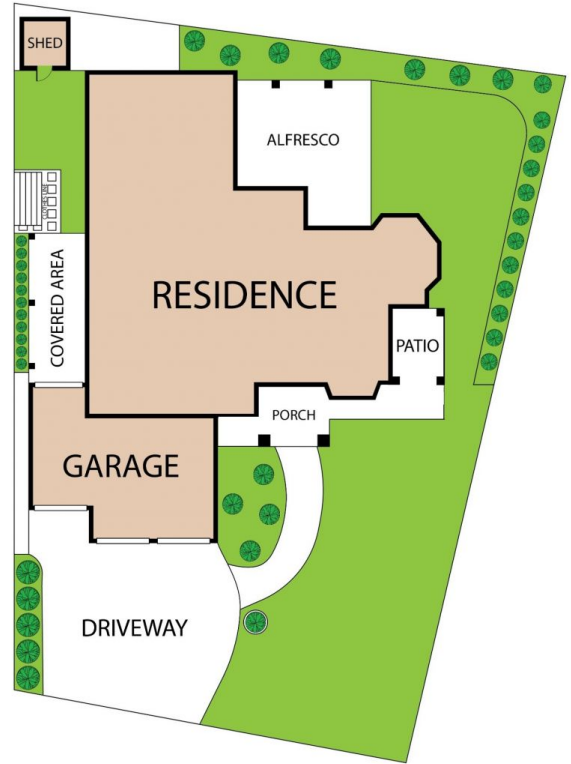
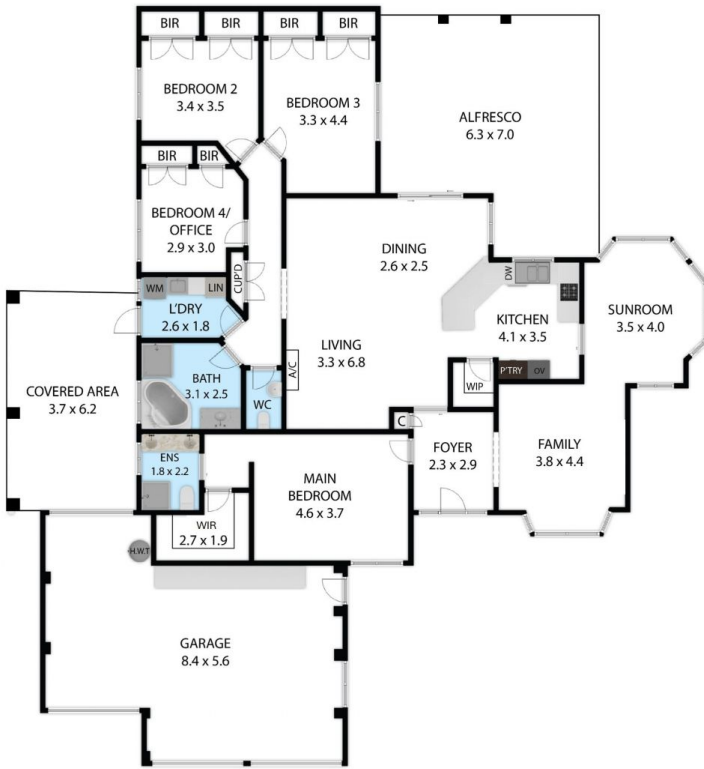

7 Lutea Place, Forster, NSW, 2428
TOTAL APPROX. FLOOR AREA 225 SQ.M

Whilst every attempt has been made to ensure the accuracy of the floor plan contained here, measurements of doors, windows, rooms and any other items are approximate and no responsibility is taken for any error, omission, or misstatement. This plan is for illustrative purposes only and should be used as such by any prospective purchaser.